

Welcome to DEPARTMENT OF EARTH SCIENCE



Information brochure to new employees

Dear new colleague

Welcome to the Department of Earth Sciences!

The first few days you will most likely feel quite overwhelmed by the many new faces, locations, and so forth. We hope that this information brochure will be helpful at the start of your stay.

Department of Earth Science (GEO) is the second largest of seven departments at the Faculty of Mathematics and Natural Sciences. The department has an academic staff of 42 professors and assistant professors, 10 researcher and 36 employees in technical and administrative functions. In addition, there around 70 research fellows and other temporary academic positions. Our employees come from nearly 30 different countries.

Head of department: [Atle Rotevatn](#)

Deputy Head: [Mathilde Bøttger Sørensen](#)

Head of administration: [Andrea Grimnes](#)

There are four research groups at GEO:

- [Geophysics](#)
- [Geochemistry and geobiology](#)
- [Quaternary geology and Paleo Climate](#)
- [Geodynamics and Basin Studies](#)

The Department has **two technical groups**:

- **Laboratories.** Leader: [Olav Bjørkelund](#), Deputy: Hildegunn Almelid.
- **Field operations, IT and seismic network.** Leader: [Stig Monsen](#), Deputy: Bent Ole Ruud.

Laboratory facilities: <https://www.uib.no/en/geo/53017/laboratory-facilites>



INDEX

1. Contact information.....5

2. Practical information.....5

Keys, mail office supplies, parking and IT. 5

Work hours and presence at work..... 6

Absence (travel, meetings, conferences, field work, illness, leave and holiday)..... 7

Health, safety and environment (HSE)..... 8

Work environment and local work for gender balance, equality, diversity, and inclusivity 9

3. What`s up at Department of Earth Science9

4. Intern information at GEO12

5. Useful links for employees at UIB:12



1. Contact information

[Management at Geo](#)

[Administration at Geo](#), 3rd floor of the Realfag building. The reception is open from 9:30 am to 2:30 pm

[Mail, invoice and visiting address](#)

2. Practical information

Keys, mail office supplies, parking and IT.

Access cards: All employees need an ID-card for entering designated buildings and rooms, for printers and copier, and as a lending card at UiB's libraries. The reception /administration will assist you with the procedure to get an ID-card.

Keys: Keys for your office can be picked up at the reception desk. At the end of your stay or period of employment, please return all keys and card to the reception.

Mail: Put external mail in the appropriate tray (marked "Ekstern post") at the department's reception desk. External mail is dispatched daily from the reception at 09-9:30 am. Employees's incoming mail trays are located in the room opposite the reception (room 3108). Incoming mail is distributed daily at around 12 am. Official departmental letterheads are to be found on TEAMS, in the TEAM "Alle ansatte ved GEO" where you all are members. You will find the letter templates under the menu "Skjema og maler". Remember to give copies of all official correspondence to administration for registration in the archive.

Office supplies: Office supplies are stored in room 3155. If anything is lacking, tell the reception.

Orders and purchases: GEO has the regular "[orders](#)" to be used for all orders at GEO. Please use them for all orders and purchases. More information about orders/purchases you will find her: at the webpage [For employees at GEO](#). Make sure you address all orders and purchases to correct appointed person. Norwegian law and regulations on public purchase apply. Procurements that exceeds NOK 100 000,- must be done by central financial services at University of Bergen. <https://www.uib.no/en/foremployees/109396/anskaffelser-og-innkjop>

Telephone: Use [TEAMS](#) for phone calls. Permanent employees and laboratories have phone numbers.

Copier/printer: The copy machines are placed in room 3108 (close to the reception) and room 3141 on the third floor, and room 2137B on the second floor [MyPrint.uib.no](#). Use keycard for the copier machines. Does the copier machine ask for puk code? Open your browser and [open here](#).

Lunchroom: Our lunchroom "Steinbiten" is at the 2nd floor opposite to the lift (room 2112). K.G.Jebsen enteret har lunsjrom i 4 etg, rom nr 4135. Water, tea and coffee are available in the lunch room and post room (3rd fl). It is not recommended to drink tap water – use the water dispensers. Everyone is

expected to tidy up after him/herself. Lunch is generally half hour between 11.30 and 13.00.

Parking: Employees and students are encouraged to use public transport and to cycle to work. [Secure bicycle parking](#) is available in several places on the university campuses. Among other things, there is room for 57 bicycles in the bicycle cage in the garage at Realfagbygget (Allégaten 41). There are no free parking spaces at UiB. Information about parking at UiB you will find [her](#).

IT-account: When new employees are registered in SAP (UiB's HR-system) normally the day your employment starts, a user account will be created automatically. As new employee you will be notified of this and must then activate the account ([more information](#)). For Unix/Linux accounts, contact Leo Zijerveld og Øyvind Natvik (GEOs IT-personnel).

Guest account short term or accounts for guest researcher long term, please contact [Trine Lise Stjernholm](#) og post.geo@uib.no.

IT-support The central IT-section of the university (<http://it.uib.no/>) is responsible for standard services such as the network, servers and clients, as well as user support (problems should be reported through the BRITA-service: tel. 84700 or via the [UiBhjelp](#). IT-support, including purchase of IT equipment and administration of printers and licenses, is provided by IT staff at each department. If you are uncertain as to who is responsible for a particular service, BRITA will direct you to the correct instance.

Wireless network Secure wireless network [Eduroam](#) is recommended for those how have access to that. Others can use [UiB-guest](#),

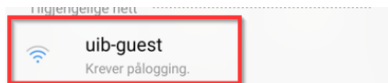

Web profile at www.uib.no: Employees are strongly encouraged to update their personal profile on web www.uib.no/user

Work hours and presence at work

Scientific personnel (Group A: professors, associate professors and researchers and Group B: post doctors, temporary researchers and research fellows)

Ordinary work hours are 40 hrs/week included 30 min lunch break. Overtime work cannot be compensated by compensatory time for scientific employees, because they don't record/register their work hours.

Opening hours at the University are 08:00-16:00 and core hours 09:00-14:30. Head of department expect that the employees are present at the department during core time.

Absence due to travel, field or other reasons, must be approved and registered before you leave.

Technical and administrative personnel (group C)

Ordinary work hours are 37,5 hrs/week included 20 min lunch break

Daily work hours in summer May 15th-September 14th: 08:00-15:00

Daily work hours in winter September 15th-May 14th :08:00-15:45

Technical and administrative personnel must be available for work task during lunch break.

Absence (travel, meetings, conferences, field work, illness, leave and holiday)

GEO needs to know who is where:

- in case of catastrophic events in the area where the employees are
- to give better service in case of inquires at the department

Full-day absence (as travels*, professional meeting, seminars, conferences, courses, home office and time off)

- **Have to be reported in advance via [GEO's absence form](#)**
- A business trip/fieldwork etc registered in advance is considered an approved business trip (a travel permit is then granted).
- Travel/field work that is not registered is not approved and this can have consequences for adverse events during travel/field work (insurance settlement, assistance, etc.) Remember to have your travel approved by your supervisor / project manager or group leader before you leave and clarify where the travel costs are to be covered.

* More information about travel and travel insurance can be found on this page: [Travel Preparation | Employee Pages | UiB](#)

Travel settlement: After the journey has been completed, send the expense through the [Self-service portal](#). More information her: [Travel expence claim and expense reimbursement | Employee Pages | UiB](#)

Permanent and temporary employees of the UiB are recommended to apply for EuroCard (credit card) through UiBs agreement for travel outlay. When using the credit card from EuroCard, travel insurance is included in the card. Read more about the insurance conditions her: <https://www.uib.no/en/foremployees/177137/travel-preparation#credit-card-and-travel-insurance>

Illness report to administration first day of absence (post@geo.uib.no) / 55 58 36 00 and to your manager (For research fellows and post doctors: your supervisor, for regular employees: group leader.)

When you arrive back to work, you need to 1, fill in the self-certification of absence and 2. Register the absence in the [Self-service portal](#). Certification from doctors normally arrives UiB electronically. If absence extends over 8 days, doctors certification is needed.

[Self-certification](#) cannot be used by newly employed the first 2 months of employment (You will need a sick leave form a doctor).

Holiday All employees are entitled to 25 days' vacation each year and you are obliged to take the vacation days you have with pay. Days of vacation must be planned and approved with your supervisor/group leader, before you apply through the [Self-service portal](#). First year of employment you might not have days of paid vacation, however you can apply for vacation days with pay in advance from next year or vacation days without pay. Please be aware that the last year of employment you might need to use all the vacation days with pay that are left, before your contract ends. Please, contact the Head of administration to make a plan for vacation. More information in your [Employees Handbook](#).

Flexible hours/time off

The technical/administrative staff has an agreement for flexible working hours and may also be able to take the time off. Record working hours and time off in my time in the [Self-service portal](#). The time off must be

scheduled and arranged with the nearest supervisor

Leave of absence (parental leave, welfare, etc.) can be applied for, through the [Self-service portal](#). Please, contact the department HR consultant for more information.

Fieldstrip/expeditions/cruise and group travels, and all trips and fieldwork with students - must also be reported by the supervisor/project manager via this form [Fields, cruises and group travel](#), well in advance of departure! More information on this page: [For employees at GEO | Department of Earth Science | UiB](#)

Health, safety and environment (HSE)

It is mandatory for all employees to familiarize themselves with [the HSE-regulations at the university, and at GEO](#).

The safety officer (Verneombud/VO in Norwegian) for 2025 to 2026 is [Leo Zijerveld](#) and the deputy is [Lubna Sami Jawad Al-Saadi](#).

HSE-responsible is the head/management of the department. Some employees assist the management in HSE work:

HSE-coordinator: [Siv Hjorth Dundas](#)

Kjemikaliereregister, Eksponeringsregister: [Hildegunn Almelid](#).

Avhending av Farlig avfall: [Siv Hjorth Dundas](#)

Strålevernansvarlig: [Desiree Roerdink](#)

Next of kin The department wishes to have information on your next of kin – please fill out the info into [Self-service portal](#).

Access to laboratories

“Declaration of received info regarding safety in the laboratory” must be signed before access to laboratories is given. Please contact Olav Audun Bjørkelund, for further information: Olav.Bjorkelund@uib.no.

<https://www.uib.no/en/geo/114561/employees-geo#access-to-our-labs>

Incident report system

Employees and students report HSE non-conformities environment in UiBs digital [deviation system](#). Such deviations are all unwanted events and/or conditions that have led to or may cause harm to people, environment and equipment/materials.

Fire

In the case of a fire alarm leave the building immediately and assemble on the south side of the Science Building (down the stairs- pass the pool). Under the roof outside the Department of Physics. Use the stairs! If possible, lock the office door. **Evacuation and meeting point:**

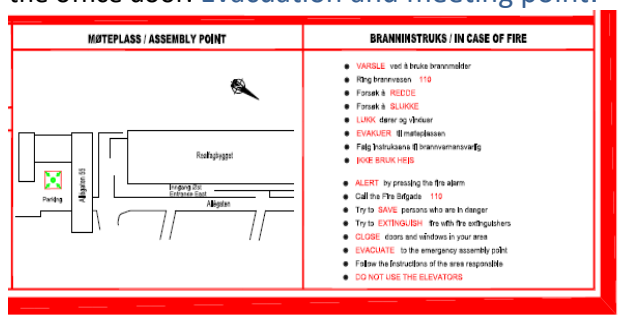

Work environment and local work for gender balance, equality, diversity, and inclusivity

The Department of Earth Science aim to have a work environment where all students, employees and guests contribute to creating a working environment where everyone are welcomed, and included on equal terms regardless of gender, race, ethnicity, age, religion, sexual orientation, gender identity, gender expression, disability, economic status, professional disagreement, political conviction, or other backgrounds.

The contact point for issues, any experiences with balancing work or the lack of it at GEO, you may want to report or simply share with someone is:

Associated professor Desiree Roerdink: desiree.roerdink@uib.no, Phone: 55 58 38 59 or other members of the local working group for local balance work ([follow link to webpage](#)).

Such issues or others related to the working environment* can also be taken up with the [Head of department](#), [Head of administration](#) or [safety representative](#) Students can register such topics/problems via [Speak up!](#).

*) Notifications from employees about objectionable matters must follow [UiB's guidelines](#) and be reported via [an electronic notification form](#).

The Department of Earth Sciences' "Action plan for local gender balance, equality, diversity and inclusion" is available on TEAMS in the team "[For alle ansatte ved GEO](#)". The aim of the action plan is to increase

3. What`s up at Department of Earth Science

The Department of Earth Sciences (GEO) aims to develop new knowledge of the Earth's structure, formation history and driving forces for its dynamic behavior.

Studies

GEO offers education at Bachelor's, Master's and PhD levels in geosciences. [Bachelor in Earth Science](#), [Bachelor in Earth Science and Informatics](#), [Master in Earth Science](#) and [Doctoral education \(PhD\)](#)

Newly employed PhD-students have 3 months to seek admission to the PhD program. Please contact your PhD-advisor [Anders B. Kulseng](#) for supplementary information: Anders.Kulseng@uib.no. PhD students who have

questions related to their studies should contact their primary supervisor. For more general questions of more study administrative nature, please contact Anders.Kulseng@uib.no.

Science

The Research activities at the department of Earth is organized into four research groups: [Geophysics](#), [Geodynamics and Reservoir Studies](#), [Geochemistry & Geobiology](#), and [Quaternary geology & Paleo climate](#).

Research Facilitates

If you want to find a specific competence at the department you can use this link: [Find a researcher by Geo](#)

GEO owns and operates a number of research laboratories with a wide Range of modern equipment for different types of analysis and laboratory testing. Read more [here](#).

GEO are partner in centre:

[iEarth \(Coordinated at GEO,UiB\)](#)

[Centre for Deep Sea Reaearch \(Coordinated at GEO,UiB\)](#)

[Bjerknes Centre for Climate Research/Centre for Climate Dynamics \(SKD\)](#)

[Norsk senter for Geothermal Energi \(CGER\)](#)

[FME \(Centre for environment-friendly energy research\)](#)

[ARCEX](#)

For Scientific Staff

Project proposal support

GEO offers support to its employees' project proposal through the research coordinator [Linling Chen](#). The research coordinator provides information and practical help in finding funding opportunities, preparing project proposals, budgeting and contracting. Information can be also found on [GEO website](#).

Registration of scientific publications in

All scientific employees at the institute are responsible for registering their scientific publications in the database Nasjonalt vitenarkiv (Current Research Information SysTem In Norway). Reasearch activities can be registered within categories such as:

- Journal article
- Conference contribution or scholarly presentation
- Book
- Report/dissertation
- Part of a book/report
- Translation work
- Media contribution

<https://nva.sikt.no/> more information here: <https://www.uib.no/en/ub/173506/nva>

The final deadline for registration is the 1st of February (for last year)



Social gatherings

Meet for lunch in Steinbiten 2nd floor: every day, some have lunch at 11:30 others at 12:30. Feel free to join 😊

GEOlunch seminar: organized by the Geophysics group and the Geodynamics and basin group, normally every Wednesday at 12:15-13:00, open to everyone at GEO. [Follow this link for more information!](#)

Information meeting for employees (including all also research fellows) - approximately once a month, employees are invited to a joint information meeting. Round birthdays (50 & 60) are also marked here with subsequent cake for everyone, and new employees are presented. The meeting is held in Aud. 5 or Aud. 2, Thursday at 12.15-13.00. A reminder will be sent by e-mail.

HSE meeting/Institute seminar/GEO day: Annual meeting for employees where we have psychosocial working environment on the agenda. Often this is combined with a geotechnical field trip in the area where the HSE meeting/institute seminar takes place.

Christmas party is arranged annually for all employees in November/December. Date and registration will be announced.

Group meetings with different social content are arranged at regular intervals in the various employee groups/research groups.

4. Intern information at GEO

GEO news (GEO-Nyheter)

Internal newsletter (in a combination of English and Norwegian) is sent out by e-mail every Friday around lunchtime. The archive of previous issues can be found on TEAMS under the TEAM «All employees at GEO». Feel free to send in a contribution to post@geo.uib.no.

Kalenderen på instituttets hjemmeside ([Upcoming events for Department of Earth Science | University of Bergen \(uib.no\)](#)) tip: More events are published on the Norwegian site than on the English version).

Information meetings

The department has information meetings about once a month in Aud. 5 or Aud 1 from 12.15-13.00. Reminder will be announced on web and on e-mail.

The department's website for employees at GEO provides an overview of internal routines and internal information: [For employees at GEO | Department of Earth Science | UiB](#)

«**For alle ansatte ved GEO**» a TEAM in TEAMS where all employees are members. Files and templates, the department only shares with employees at GEO, are collected here (archive for GEO Nyheter, minutes from meetings, letter templates etc).

Also follow the UiB's key pages for employees: <http://www.uib.no/foransatte> and the [faculty's](#) pages.

Geo on social media:

Facebook: <https://www.facebook.com/earthscienceuib>

Instagram: <https://www.instagram.com/uibgeo/>

LinkedIn: <https://www.linkedin.com/in/institutt-for-geovitenskap>

5. Useful links for employees at UiB:

For personal info from employee sides to UiB; <http://www.uib.no/en/foremployees>

- Work support – Human resources HR here you find info like [employee handbook](#) (info as [New at UiB](#), [Contracts / working hours](#), [Salary, travel and absence](#), [pension](#), and [insurance](#), etc.
- [Holiday](#), [flexitime](#), [Broadband](#) etc
- [Self-service portal](#) - paycheck, record your vacation, absence and leave, filling out travel expense and record kin information, telephone etc.
- [The HSE-Gateway](#), Security, [Fieldwork/research cruises](#), [Physical activity](#), etc
- [Competence development](#), [training](#) etc.
- [Welfare](#), Cultural events, welfare and leisure, cabins etc